

ADAPTOR ADP USB

Contents

1	SAFETY INSTRUCTIONS.....	2
2	DESCRIPTION.....	2
3	TECHNICAL DATA	2
3.1	MECHANICAL DATA	2
3.2	ELECTRICAL DATA	2
3.3	ENVIRONMENT, STANDARDS.....	2
4	OVERALL DIMENSIONS	3
5	CONNECTION.....	3
6	SAFETY SYMBOLS AND MARKINGS.....	4

1 SAFETY INSTRUCTIONS



: WARNING: The adaptor must be powered by a LIMITED POWER SOURCE.

If the sensor is used in an unspecified manner, the protection provided by the adaptor may be compromised. Details of symbols and safety markings are provided on the last page of this documentation (§6).

2 DESCRIPTION

The ADP-USB is a **PARATRONIC** adaptor which allows a PC to be interfaced via a USB port to:

- A 4/20mA underwater sensor from the SNA, SNC, etc. range
- An RMA radio module
- Two RS485 ports (1 master and 1 slave).

In its sturdy casing, it is intended for occasional use as and when required, particularly for on-site adjustments and troubleshooting using a laptop PC.

The ADP-USB is used via the **PARATRONIC** "sensor HMI" (see sensor HMI manual) and a USB driver to be run during installation (Paratronic_USB.exe). Download the latest version of the software from www.paratronic.fr/catalogue on the pages for the compatible sensors. Installation of the **PARATRONIC** "Sensor HMI" software requires Administrator permissions on the computer.

3 TECHNICAL DATA

3.1 MECHANICAL DATA

Description:	ABS Plastic box
Dimensions (mm):	L=121, H=66, H=41
Weight (g):	180

3.2 ELECTRICAL DATA

Power supply:	External power supply or via the USB port
External power supply type:	SELV (source with power limited to 0.150mA)
External voltage:	15 V DC (14.5 to 16.5V DC)
Power consumption:	50mA + power consumption by connected components powered by the ADP USB
Current limit:	50mA (total maximum consumption provided to inputs/outputs).
External power supply connection:	Jack dia. 2.1 mm (positive central contact)
PC link:	USB port type B
Detachable connections:	Screwed, in polyamide 6.6 for wires of cross-section 0.5 to 0.75 mm ² , tightening torque 0.5 Nm (0.6 Nm max)
RMA radio module:	4-point connector
RS485 no. 1:	3-point connector
RS485 no. 2:	4-point connector
4/20mA sensor:	2-point connector
Power on indication:	Red LED

3.3 ENVIRONMENT, STANDARDS

Maximum altitude:	2000 m above sea level
Protection rating:	IP20
Storage temperature:	-20 to 60°C
Operating temperature:	-20 to 50°C
Electromagnetic compatibility:	Rapid transients level 4 Lightening shock wave 8/20, 2Kv EN 61000-6-2, EN 61000-6-3
Electrical safety:	EN 60950-1
Health:	EN 62479

EC marking:



4 OVERALL DIMENSIONS

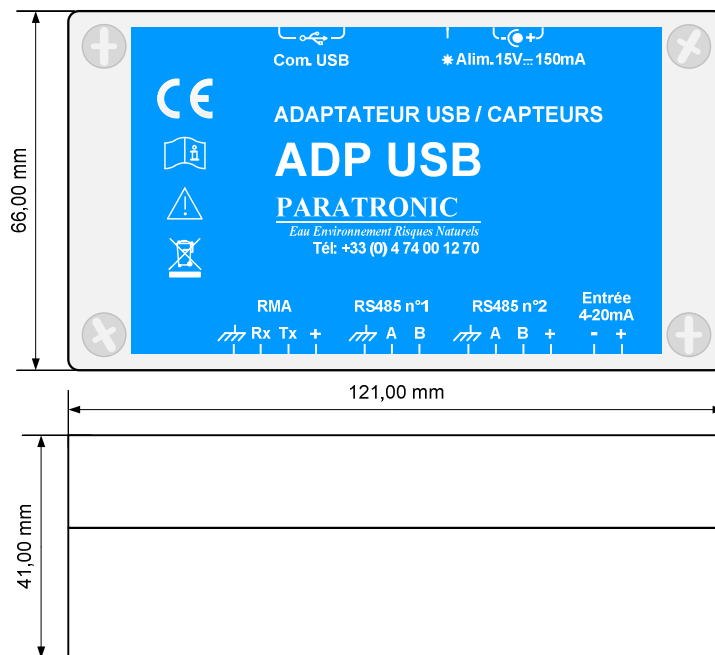

5 CONNECTION

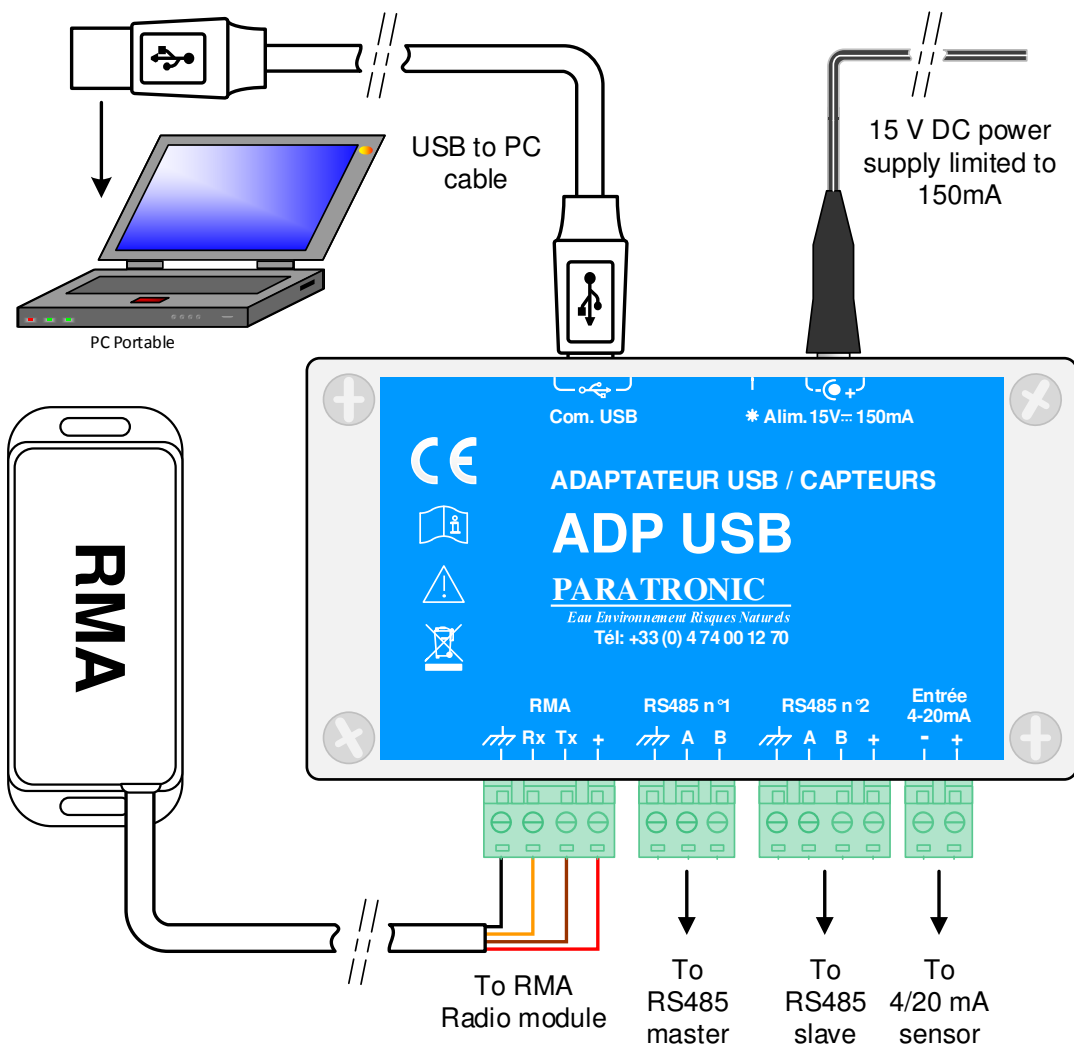

6 SAFETY SYMBOLS AND MARKINGS

 : Risk of danger: Important informations. Refer to the instructions.

 : Read the instructions.

 : Complies with the European Union and EFTA directives.

 : European directive 2002/96/CE of 27 January 2003, concerning waste electrical and electronic equipment (WEEE Directive) has been transposed in France by Decree No. 2005-829 of 20 July 2005.

Electrical or electronic appliances, as well as their spare parts and consumables must never be disposed of in domestic waste.

PARATRONIC has undertaken to set up an Individual Collection System.

Customers (end users) are requested to return **PARATRONIC** electrical and electronic equipment waste to the following address:

PARATRONIC - Zone Industrielle - Rue des Genêts, 01600 REYRIEUX, France.

WEEE Recycling Department